

## MAINTENANCE

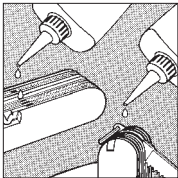

Extend each implement halfway, then apply a few drops of oil at the base of that implement. For blades that do not move easily, open and close a few times in warm water, then dry and oil. This care will insure a lifetime of faithful service.

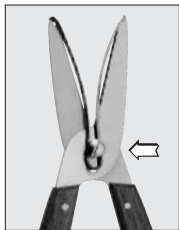

Unscrew the cutting edges of the Harvester. Apply a few drops of oil where the blades contact each other. Reassemble the tool. This will ensure a lifetime of faithful service from your gardening tool.

## VICTORINOX GUARANTEE

Victorinox guarantees all multi-tools to be of first class stainless steel, and provides a lifetime guarantee against any defects in material and workmanship.

## WARRANTY

Swiss Army Brands, Inc., warrants this Victorinox product to be free from defects in material and workmanship for the entire life of the multi-tool. If your multi-tool has a manufacturer's defect covered by our warranty, we will either repair or replace it, at our option, without charge when it is returned to a Victorinox Authorized Dealer or sent to:

Swiss Army Brands, Inc. Service Center • P.O. Box 897  
65 Trap Falls Road • Shelton, CT 06484-0897

Please include your name, address and phone number with your return.

## REPAIRS

A damaged multi-tool not covered by the warranty can be repaired for a nominal fee. Please return the damaged multi-tool with a letter explaining the requested repair, to the above address. You will then receive a letter confirming the cost of that repair before the repair is done. Mail form with check, money order or credit card information or call our customer service number to give approval with credit card number.

## CUSTOMER SERVICE



Only when you see the name Victorinox® stamped on the blade can you be assured you have the Original Swiss Army™ Knife.

### Replacement Parts

Call customer service or visit us at [swissarmy.com](http://swissarmy.com) to find an Authorized Dealer near you.

Customer Information • 1-800-442-2706

## OUR LEGACY

In 1884, Karl Elsener opened his cutlery workshop in Ibach, Switzerland. In 1891, he obtained the first contract to supply the Swiss Army with a "Soldier's Knife." Six years later, he invented the "Swiss Officer's Knife" which was officially registered on June 12, 1897. Since that time, the Victorinox® Original Swiss Army™ Knife has become well-known in more than 100 countries for precision, quality, functionality and versatility.

Enjoy your new Victorinox multi-tool. You will find it to be an invaluable companion.

14567

# VICTORINOX

GARDENING TOOLS

## OUR PRODUCTS

Inspired by our heritage, the Victorinox® spirit has been captured by our designers in a broad range of inventive, classically designed products that break new ground in performance, versatility and value.

From our completely new line-up of Swiss Army® Watches, to our innovative line of Victorinox Travel Gear and Apparel, you'll find the uncompromising craftsmanship and attention to detail that make all of our products worthy to carry the Victorinox emblem.

For more information about our complete line of products, please visit us on-line at [www.swissarmy.com](http://www.swissarmy.com).

## GARDENING TOOLS



Gardener

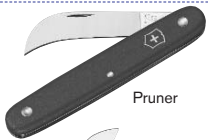

Pruner



Grafter



Harvester

## FEATURES

### Gardener

Sheepsfoot Blade

### Pruner

Pruning Blade

### Grafter

Sheepsfoot Blade  
Grafting Blade

### Harvester

- Unique patented "cut and hold" feature allows you to gather stem, then cut in one simple motion.

- Holding spring and varnished hardwood handles crafted for comfortable cutting with one hand.

## Budding Instructions

Budding is a form of grafting on shrubs and woody plants that enables a new plant variety to grow on mature rootstocks. Thus several varieties of apples, for example, can be "budded" onto one tree. It is a simple technique that inserts a bud shoot under the bark of another shrub or tree. The bark is cut open with a T-cut and detached with the bark remover. **Season to bud a plant: In early to mid summer**

1. Cut off a stem from the shrub or tree variety you want to bud. Trim away the leaves, leaving the leaf stalks on the stem. Immerse the stem in water until it is needed. Take care to remove the thorns from the rose stem before trimming leaves.

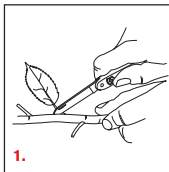

1.

2. Next, cut the rootstock with your Victorinox grafting multi-tool as shown. First, using the arched part of your tool, gently cut a small horizontal no deeper than the bark surface. Then centered approx. 0.75" (2 cm) beneath the horizontal cut, gently cut bark in an upward motion. The final should look like T-shaped slits in the bark. Close your knife, and with the base of the knife, gently peel back the bark slightly. Note that since tree sap flows most freely in the summer season, the bark should separate freely from the tree.

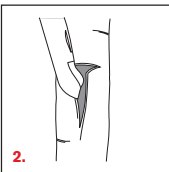

2.

3. Remove the stem from water, and dry so it is not slippery in your hand.

4. Holding the stem firmly in one hand with the top of the stem in your hand, choose one of the buds that is uppermost on the stem. Taking your Victorinox grafting tool, insert the knife blade below the bud and guide the knife carefully toward you, keeping the knife blade flat, just under the bud surface. Don't start the cut too close to the bud; once cut, the bud should be about 1" (2-3 cm) in length. Rose bud length should be much shorter.

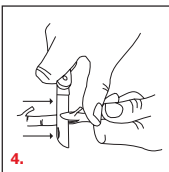

4.

5. Examine the base of the bud carefully and remove a sliver of wood in the center. Remove it with the tip of the knife.

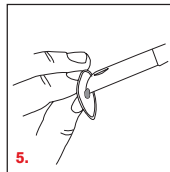

5.

6. Holding the leaf stalk, take the bud and slide it into the T-shaped slit on the rootstock. When the bud is secure, trim the excess bark and tie the bud onto the tree.

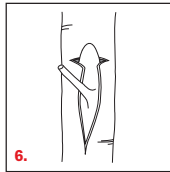

6.

7. Later on when the bud has new shoot growth, carefully cut away the ties. In autumn, make sure to prune off the rootstock growth above the new shoot.

## Pruning

Pruning, the act of cutting back weak or dying shoots, is an effective way of rejuvenating any plant. The "when" and "how to" pruning standards are as varied as the many plants grown. The Victorinox pruning blade can help you get clean cuts.

## Grafting

Whip grafting is one of several grafting methods. This grafting technique is used for ornamental plants that do not respond to budding, and also used for grafting a variety onto a rootstock. Another method of grafting, Cleft grafting, is used to put another variety onto a fruit tree to provide a pollinator. Ask your local nursery how to graft properly. **Season to graft: Late winter or early spring**